

# X-JET NOZZLE

Long Range External Chemical Injection

## FEATURES

- Two versions to choose from.
  - Original X-Jet with fixed long and close range spray patterns
  - X-Jet M5 with Adjustable spray pattern from 5 to 60 degree spray pattern
- Apply soap & rinse with the same nozzle
- Projects chemicals up to 40ft or more depending on your machine
- NO chemicals run through the pump, hose, reels, gun, lance, or quick connects
- Color coded proportioners to apply chemicals at desired ratios

## The Original X-Jet

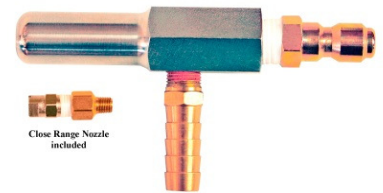

## X-Jet M5



## SPECIFICATIONS

Style	The Original X-Jet (Fixed)						X-Jet M5 (Adjustable)					
Model	XJET-07K	XJET-09K	XJET-13K	XJET-16K	XJET-20K	XJET-25K	XJETM5-07K	XJETM5-09K	XJETM5-13K	XJETM5-16K	XJETM5-20K	XJETM5-25K
Operating Pressure	2000-3000 PSI	2000-3000 PSI	2500-4000 PSI	2500-4000 PSI	2500-4000 PSI	2500-4000 PSI	2000-3000 PSI	2000-3000 PSI	2500-4000 PSI	2500-4000 PSI	2500-4000 PSI	2500-4000 PSI
GPM Flow	2 - 2.5 GPM	3 - 3.5 GPM	4 - 4.5 GPM	5 - 6.5 GPM	7 - 8 GPM	8.5+ GPM	2 - 2.5 GPM	3 - 3.5 GPM	4 - 4.5 GPM	5 - 6.5 GPM	7 - 8 GPM	8.5+ GPM
Max Temperature	190° F						190° F					
Port Sizes	Inlet 1/4" MPT x 1/4" QC Plug						Inlet 1/4" MPT x 1/4" QC Plug					
	Chemical Port 1/8" MPT x 3/8" Hose Barb						Chemical Port 1/8" MPT x 3/8" Hose Barb					
Kit Weight	2.6 lbs						2.8 lbs					

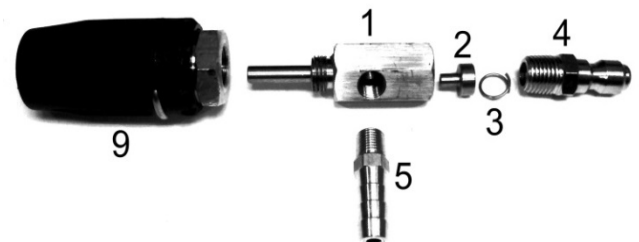
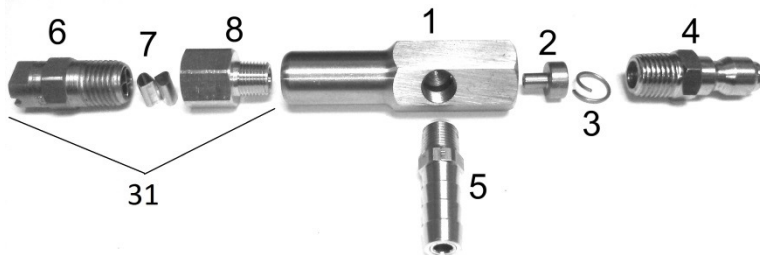

Item	Part	Description
1	N/A	X-Jet body-Not sold separately
*2	OR(X)	Orifice (X is selected size 7,9,13,16,20,25 (See model number in chart above)
3	XSPR	Spring
4	XMP	1/4" MPT x 1/4" Quick Connect Plug
5	XSHB	Chemical Hose Barb
6	XCRMN	Close Range Meg Nozzle
7	XCRNRV	Close Range Nozzle Vane
8	XCRNA	Close Range Nozzle Adapter
**9	XM5RVN	Variable Nozzle (See note below)
31	XCRNAS	Close Range Nozzle Assembly (Items 6-8)

\*Special Order sizes available for machines larger than 8.5 GPM

\*\*Replaceable; However, be advised variable nozzle is machined on to X-Jet body at factory for proper vertical fan orientation. With replacement by hand, orientation of spray pattern cannot be guaranteed.

Item	Part	Description	Item	Part	Description
10	XJH	3/8" Hose per ft	20	XPP-BLUE	Blue Proportioner
11	XSPDC	Clamps (2)	21	XPP-TAN(MED)	Tan Proportioner
12	XSOV	Shut Off Valve	22	XPP-GREEN	Green Proportioner
13	XBSHB	Hose Assembly Barb	23	XPP-ORANGE	Orange Proportioner
14	XBS	Ball Strainer Screen	24	XPP-BROWN	Brown Proportioner
15	XPP-GREY	Grey Proportioner	25	XPP-YELLOW	Yellow Proportioner
16	XPP-BLACK	Black Proportioner	26	XPP-AQUA	Aqua Proportioner
17	XPP-BEIGE	Beige Proportioner	27	XPP-PURPLE	Purple Proportioner
18	XPP-RED	Red Proportioner	28	XPP-PINK	Pink Proportioner
19	XPP-WHITE	White Proportioner	29	CLEAR	CLEAR NOT USED



Kit	XJET-XX	Original X-Jet Kit (Items 1-8, 30 & 32) XX is selected orifice size
Kit	XJETM5-XX	M5 X-Jet Kit (Items 1-5, 9, 30, & 32) XX is selected orifice size
30	XPP-PACK	Proportioner Pack (Items 15-29)
31	XCRNAS	Close Range Nozzle Assembly (Items 6-8)
32	XHA	Hose Assembly (Items 10-14)



## INSTALLATION

**Read the instructions & warnings included with your X-Jet Kit in its entirety before installation. Determine the X-Jet model you need based on the operating pressure and GPM of your machine. Connect the X-Jet to the gun or lance via a 1/4" quick connect coupler (not included). Make sure it is properly connected before turning the pressure on. Always aim the nozzle away from all surfaces and people when first turning the pressure on to ensure the X-Jet is securely connected. Never aim the nozzle towards any person or animal in any circumstance. Always use the proper personal protective equipment when using the X-Jet Nozzle. Under no circumstances should the pressure of the pressure washer in use exceed the maximum rated pressure of any component.**

## TROUBLESHOOTING

Problem	Cause	Solution
X-Jet will not draw chemical	Shut off valve in hose has failed Shut off valve is closed Incorrect orifice size Crack in chemical hose Debris is in barb or hose Pressure Washer is not working properly	Replace shut off valve Twist valve to open position Replace orifice with correct orifice size Replace chemical hose Clean debris out of hose or barb Verify proper operating pressure & GPM
Water is shooting out hose barb	Missing or Incorrect orifice size Debris is in orifice	Install or replace with correct size Clean debris out of orifice
Water stream is too misty	Incorrect orifice size Pressure Washer is not working properly	Replace orifice with correct orifice size Verify proper operating pressure & GPM
Water stream does not shoot far	Close range nozzle is attached to original X-Jet Incorrect Orifice Size Adjustable M5 nozzle is in closed position Pressure Washer is not working properly	Remove close range nozzle Replace orifice with correct orifice size Twist the adjustable nozzle to open Verify proper operating pressure & GPM
<b>Questions ?</b> X-Jet Technologies, Inc. 1-800-983-7467		